

cod.1482M1124

ELLIPSIS 30 B

EK

**Elektriko-Electric-Électriques
Elektrische-Eléctrico-Elétrice**

Istruzioni di montaggio ed uso
Operation instructions
Instructions de montage et usage
Montage-und Bedienungsanleitung
Instrucciones de montaje y uso
instrucțiuni pentru montare și utilizare

IRSAP

IRSAP SPA
45031 Arquà Polesine (RO) Italy
Tel. +39 0425 466611
Fax +39 0425 466662
Web: www.irsap.com
E-mail: support.heat@irsap.com

IR GROUP SARL
19,Chemin de la Plaine 69390 Vourles (France)
Tel. +33 04 28 00 01 67
Fax +33 04 72 31 86 40
Web: www.irsap.com;
E-mail: support.heat@irsap.com

IRSAP IBERICA S.L.
Oficina y Almacén: P.I.CAMI RAL
Leonardo da Vinci,4 08850 Gavà (Barcelona)
Tel. +34 93 633 47 00
Web: www.irsap.com;
E-mail: www.informacion@irsap.com

IRROM Industrie S.R.L.
Str. Principala 1/A, Sat Fundatura, Iclod 407336,
jud. Cluj, Romania
Tel: +40 (0)264 263400
Fax: +40 (0)264 263404
Web: www.irsap.ro

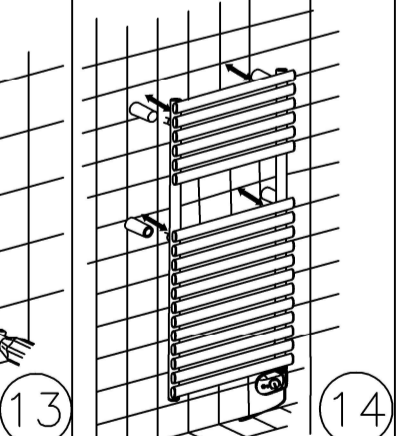
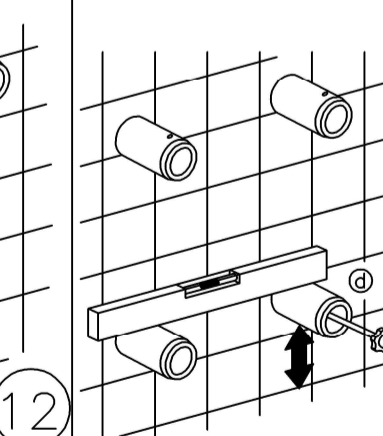
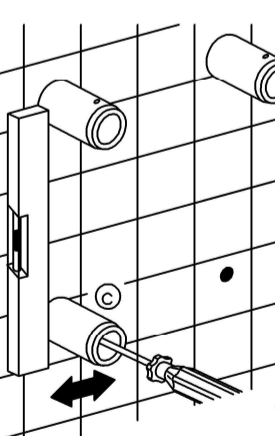
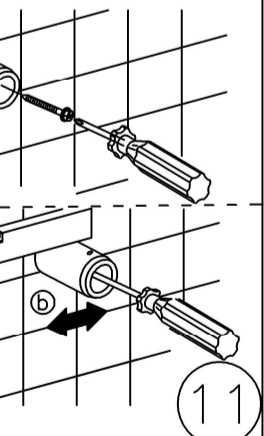
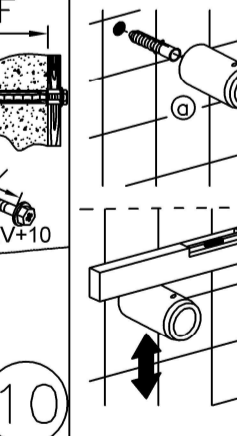
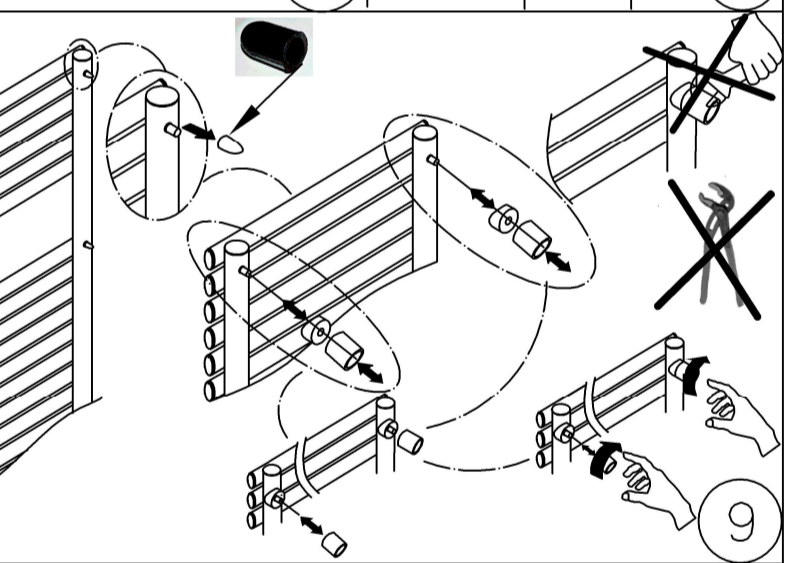
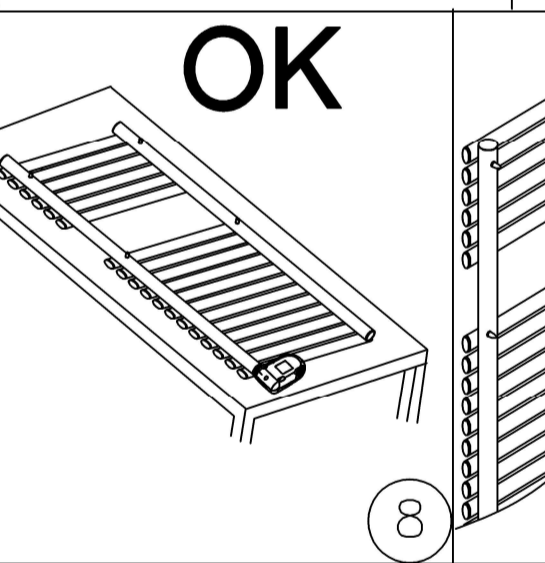
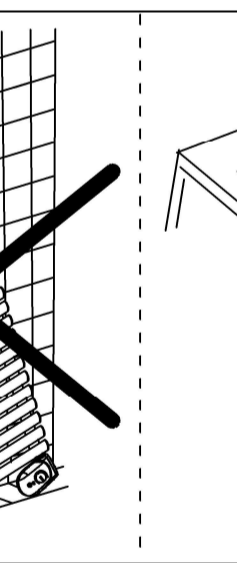
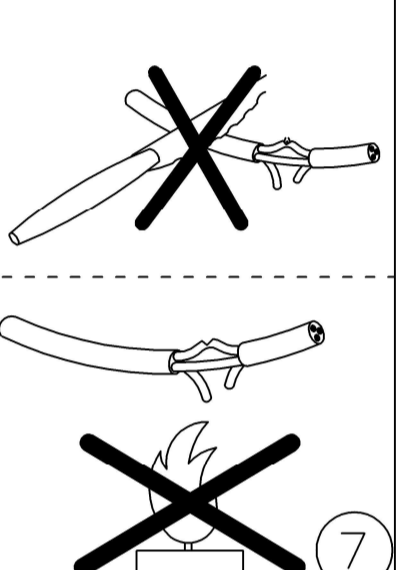
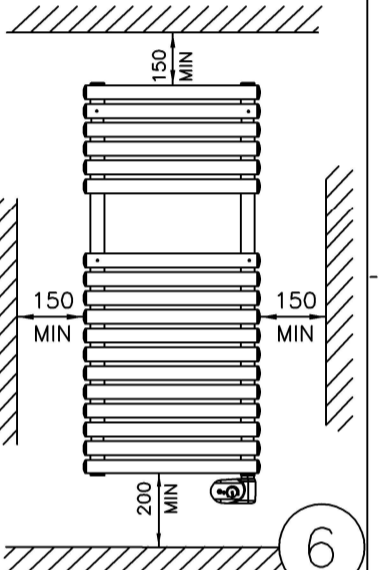
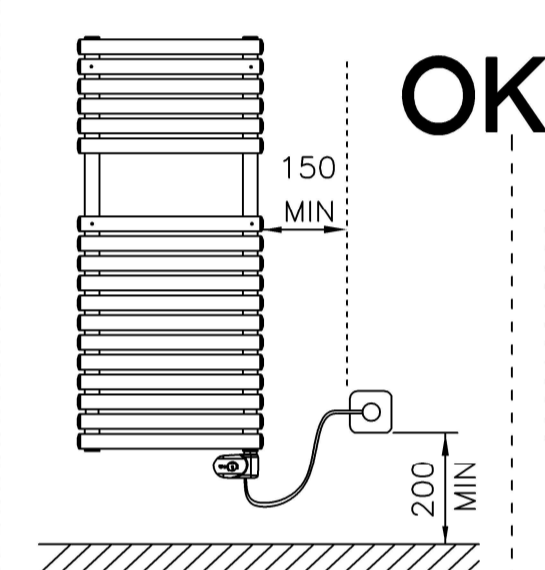
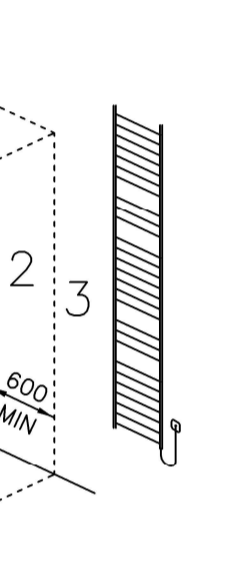
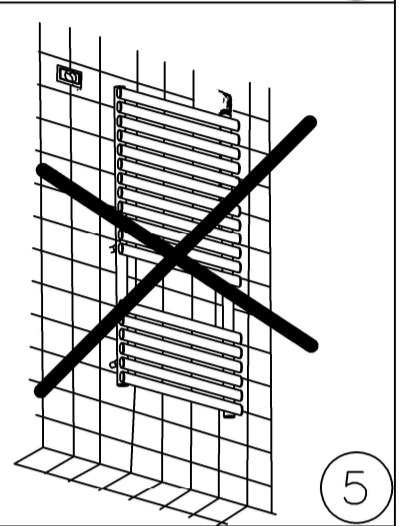
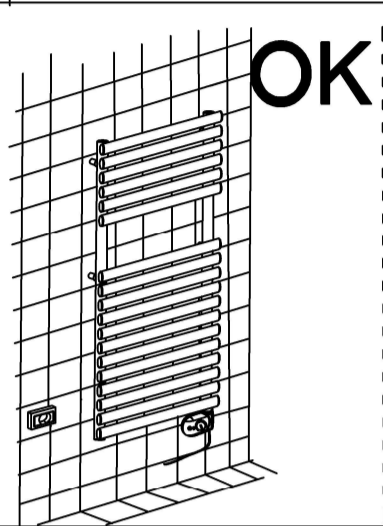
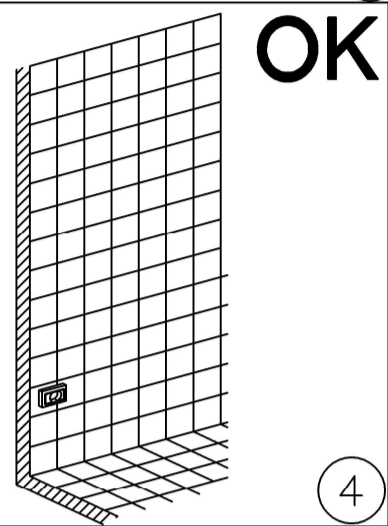
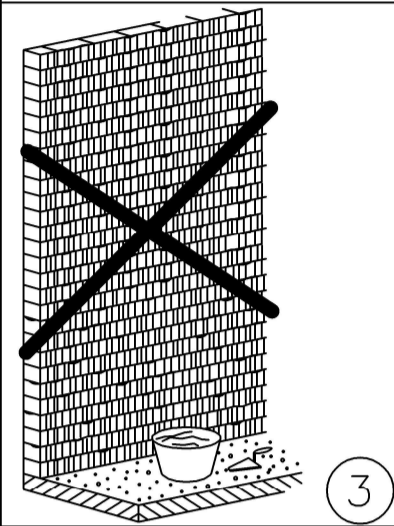
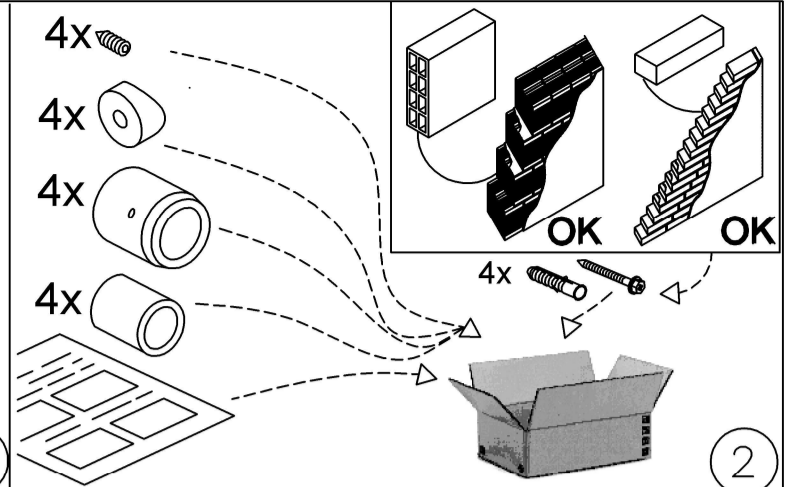
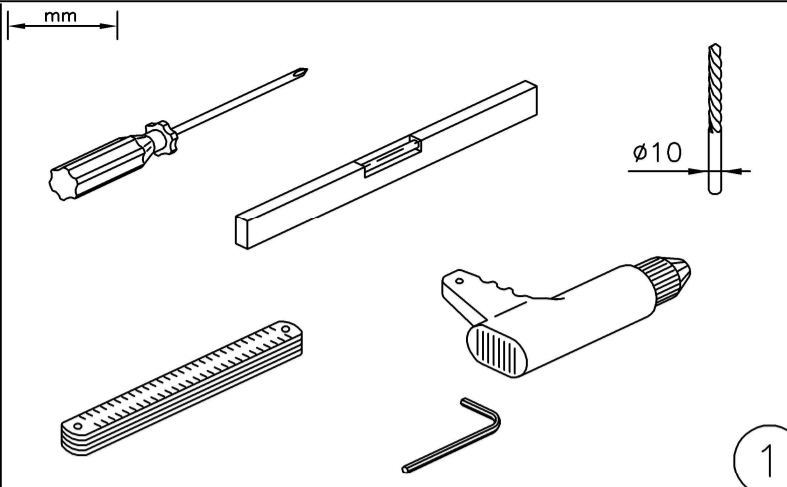

H	L	L'	W
840±2	510	450±2	320
	610	550±2	
1120±2	510	450±2	520
	610	550±2	
1560±2	510	450±2	920
	610	550±2	
1800±2	510	450±2	1120
	610	550±2	

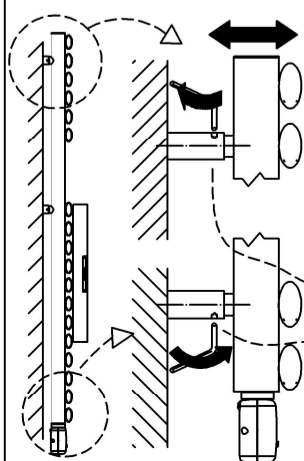

Avvitare il grano a brugola affinché il pezzo W sia fissato in maniera adeguata.
Visser la vis jusqu'au fond du filetage de manière à bloquer complètement la pièce W.

Apriete el tornillo Allen hasta que la pieza W esté fijado de manera adecuada.

Tighten the Allen screw until the component W is fixed in the appropriate way.

Înfiletați șurubul cu cap hexagonal astfel încât piesa W să fie fixată în mod adecvat.

Schrauben Sie die Inbusschraube, so dass das Stück W ausreichend gesichert ist.

