

QUADRAQUA



QUADRAQUA

height 1828 mm, lenght 300 mm. Standard White finish (cod. 01).
Designed by Domenico De Palo

**Technical features:**

- radiating panel
- 1/2" Gas right threading
- maximum working pressure 4 bar
- maximum working temperature 95°C

Price included:

- angle pattern valve and lockshield valve assembly complete with copper fitting (12, 14 and 15 mm diameter) multilayer (14 thick 2 and 16 thick 2)
- kit of pipe covers (suitable for pipes up to 16 mm thick)
- 4 wall fixing
- air vent

Finishes available	Surcharge
---------------------------	------------------

Standard White

Classic finished

Special finished

Other RAL colors

Finishing codes see page 596.

QUADRAQUA S

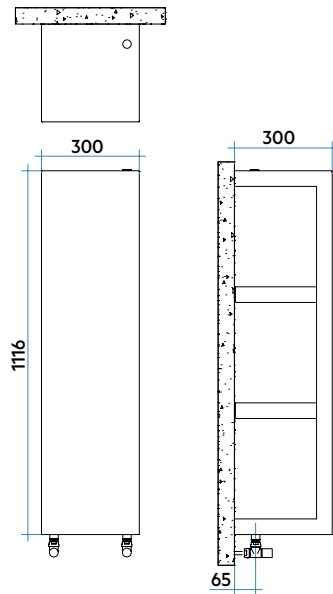

QUADRAQUA L

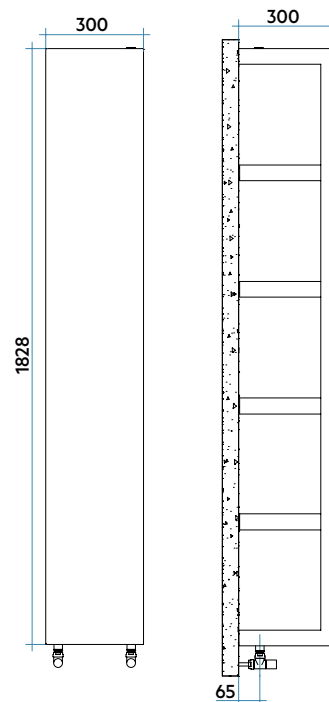

Model	Code	Depth mm	Height mm	Width mm	Conn. C. mm	Weight Kg	Cap. lt	Thermal Power				Exp. n.	
								$\Delta t=50^{\circ}\text{C}$ Btu/h	$\Delta t=50^{\circ}\text{C}$ Watt	$\Delta t=40^{\circ}\text{C}$ Watt	$\Delta t=30^{\circ}\text{C}$ Watt (*)		$\Delta t=20^{\circ}\text{C}$ Watt
QUADRAQUA S	QDRS030B XX IR NNN	300	1116	300	224	29,0	2,3	1423	417	317	223	136	1,222
QUADRAQUA L	QDRL030B XX IR NNN	300	1828	300	224	44,3	3,5	2238	656	497	348	211	1,240

(*) Thanks to the high performance of Irsap QUADRAQUA radiators, the ideal Δt for low temperature projects is Δt at 30°C .

For Δt different from 50°C use the formula: $Q=Q_n (\Delta t / 50)^n$

Key Codes

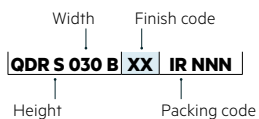

Decorative & Technical Accessories

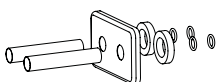

Pipe cover kit
Pag. 566

